

Single Handle 3/4" Thermostatic Valve Trim Kit

SPECIFICATIONS

Features/Benefits

- Requires Single Handle 3/4" Thermostatic Valve, D155000BT, Sold Separately
- Controls Temperature for Thermostatic Shower Systems
- Includes Escutcheon and Control Handle Assembly
- Requires Separate Shut Off/ Volume Control Valve and Trim, Sold Separately
- Deep Wall Extension Kit, D155001BT, Sold Separately



Available Color/Finishes

Color	Description
-------	-------------

	Chrome
---	--------

Please see danze.com or current price list for available finishes.
Finish is defined by additional suffix.

Standards & Certifications

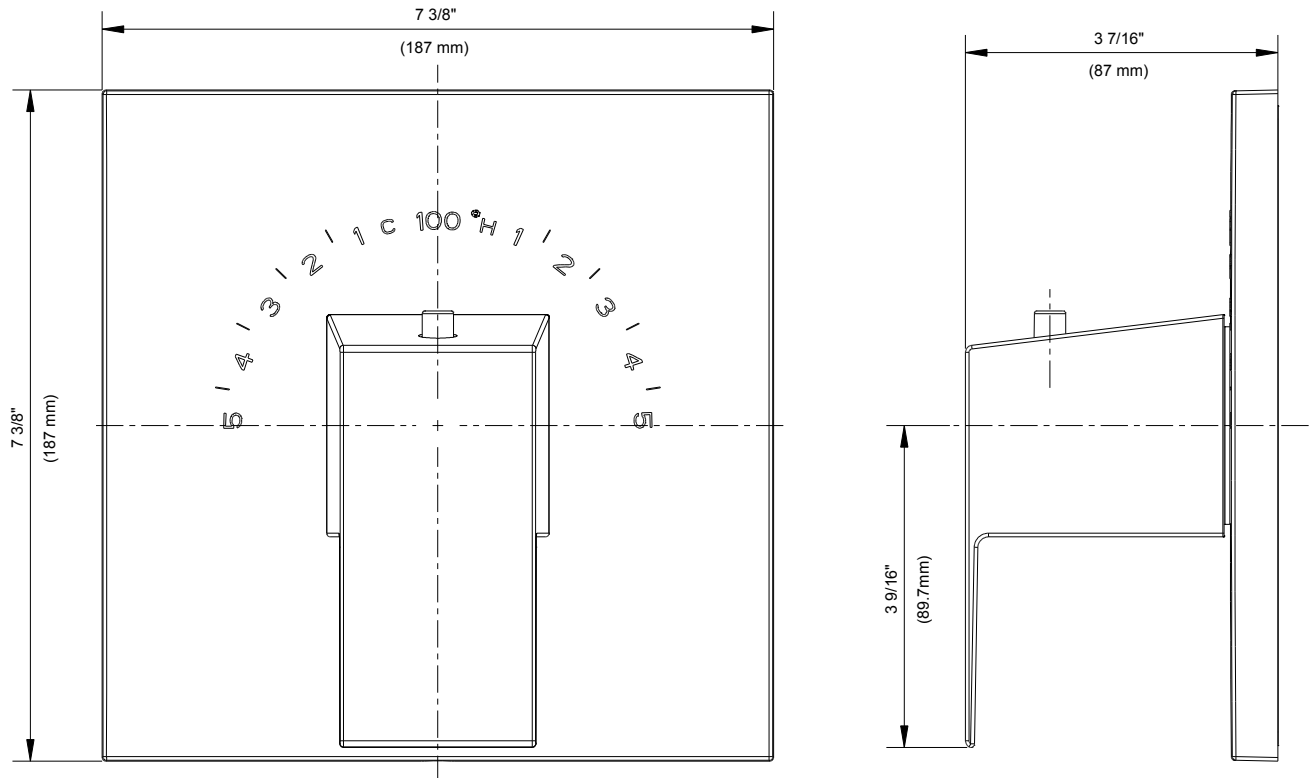

Submittal Information:

Name: _____ Contractor: _____
Location: _____ Contact #: _____